

**P.C.B. Socket 1.27mmX2.54mm(0.050"X0.100")**

**GXCON**

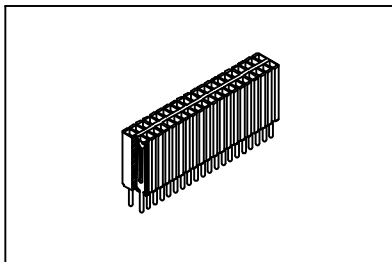

**Material:**

**Housing:** High temperature housing withstands IR and VPR soldering methods.

**Contacts:** Phosphor Bronze.

**Plating:** Gold plated over nickel.  
Tin plated over nickel.

**Electrical Characteristics:**

**Current Rating:** 1 AMP.

**Insulator Resistance:** 5000M $\Omega$ min. at DC 500V.

**Contact Resistance:** 20m $\Omega$ max. at DC 100mA.

**Operating Temperature:** -65°C~+125°C.

**Max Processing Temperature:** 230°C for 30~60 seconds.

**Mechanical Characteristics:**

**Insertion Force:** 140g avg.(0.46mm sq. pin)

**Withdrawal Force:** 114g avg.(0.46mm sq. pin)

**Features:**

- \* Straight type.
- \* Low profile 8.50mm(0.335").
- \* Mates with 0.46mm(0.018") square pin.

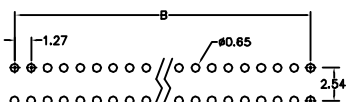
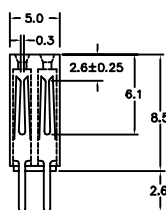
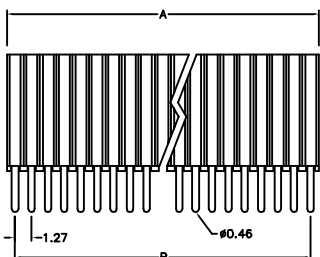

P.C. Board Layout

Position	6 Thru 100
Dimension	
A	1.27 X No. of Positions /2
B	1.27 X No. of Positions /2-1.27

**Ordering information**

PS26- 2      50      1      1  
 Series Double Row No. of Pin Per Row 1: Gold Plated 2: Tin Plated 1: Straight